



#### PLEASE NOTE:

All acrylic parts have protective film applied on both sides.

Some pieces appear with slightly translucent film, this will need to be removed before assembly.

Ensure all engraved lines face outwards.

## INSTRUCTIONS FOR: LE River Steamboat (21356) Display Case

LDS725

### Parts list:

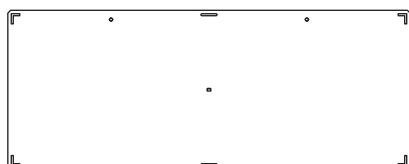

1 - PRT1

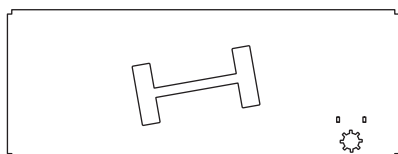

2 - PRT2



3 - PRT3

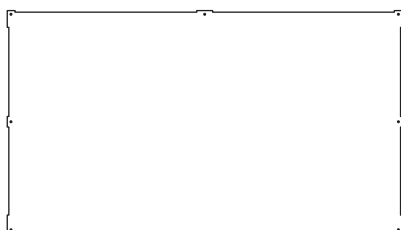

4 - PRT4

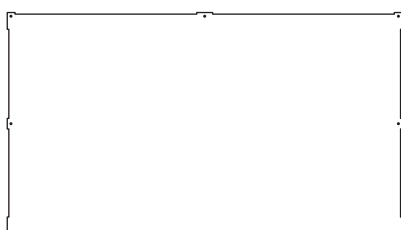

5 - PRT5



6 - PRT6

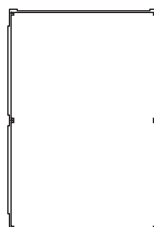

7 - PRT7



8 - PRT8



9 - PRT9



10 - PRT10



11 - PRT11



12 - CPT3 (7x packs)



13 - CPT2 (1x packs)



## INSTRUCTIONS FOR: Wicked Brick Display Cases

These instructions cover the basic directions for the majority of our display case products.  
More specific details will be found on your chosen products website listing.

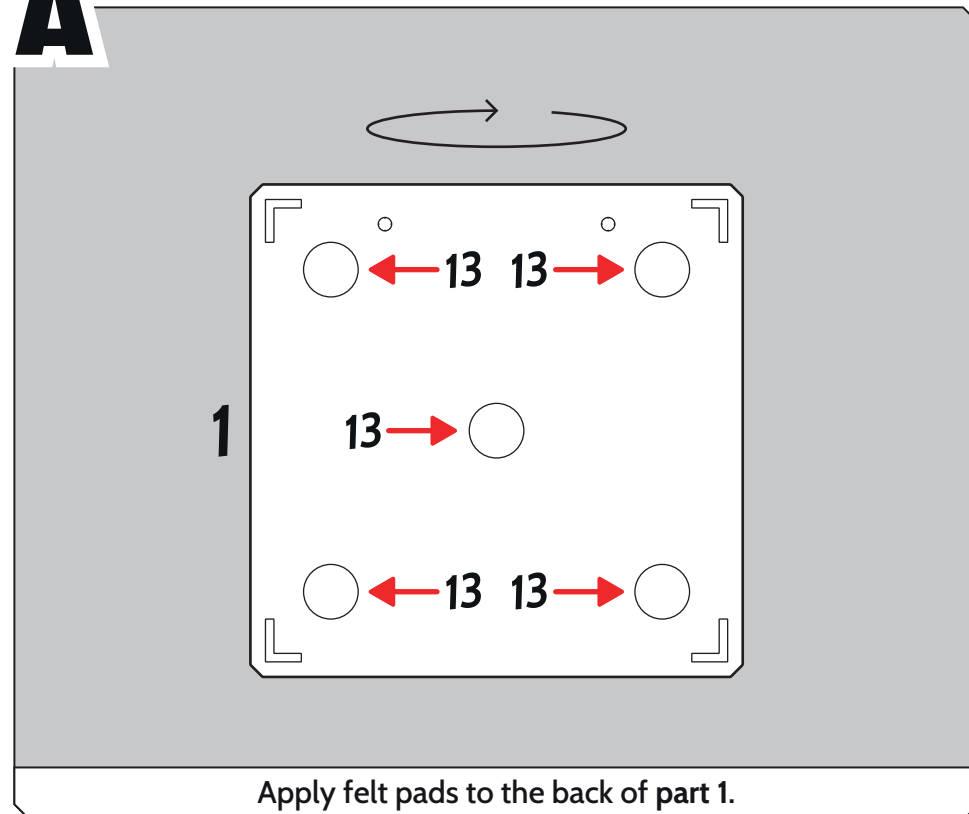
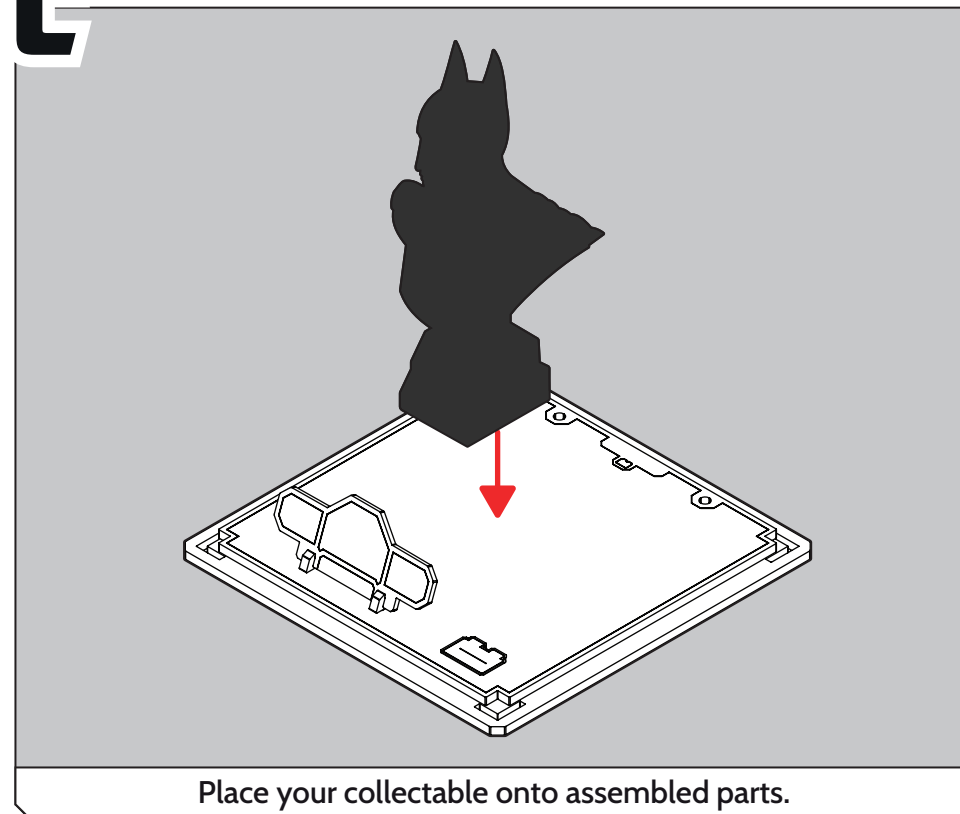
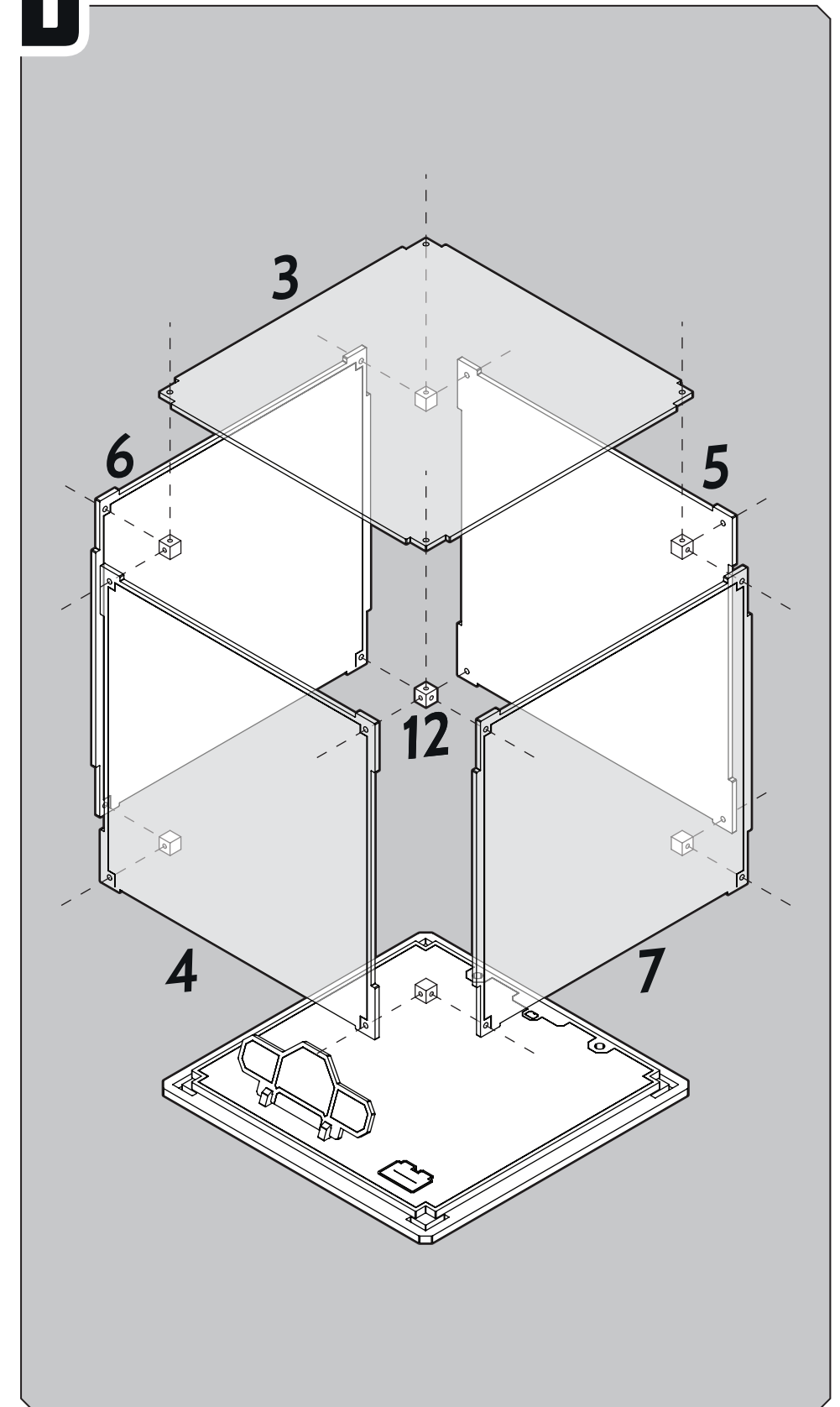
**A****C****D****B**